



BERKSHIRE  
HATHAWAY

HomeServices  
Ambassador Real Estate

Beaver Lake Ranch Home



8821 Verdon Cir  
Plattsmouth, NE 68048



4,605 Sqft



5 bed, 3 bath



\$645,000



<http://8821VerdonCir.com>



THIS HOME IS  
**ALWAYS OPEN ONLINE™**  
TAKE A VIRTUAL TOUR!

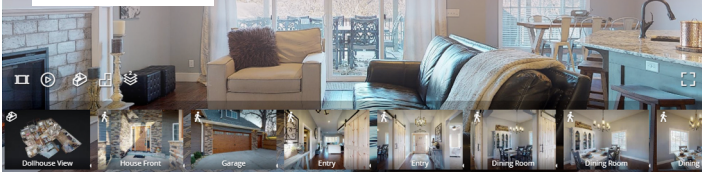

**Cory Fuller**  
Omaha Fuller Group  
BHHS Ambassador Real Estate



c: (402) 680-2393  
e: [cory.fuller@bhhsamb.com](mailto:cory.fuller@bhhsamb.com)  
w: [www.402HomeTeam.com](http://www.402HomeTeam.com)



## DESCRIPTION

---

One of Beaver Lake's finest homes in one of Nebraska's best lake communities with no worries of flooding, only 15 minutes South of the Metro! The best of all worlds, as you enjoy the peace and tranquility of a "forest-feel" lot with full lake access tucked away at the end of the cove! This custom built 5 bedroom home boasts over 4,600 finished sqft, has the feel of a mountain lodge, and high-end features and finishes throughout. The spacious living areas make entertaining a pleasure, while the basement has a bar and theater area that will make you never want to leave home. Enjoy one of the prettiest lots you will ever see, year-round, on either the massive lodge-feel covered deck or the patio, which both span the length of the house. Recreation abounds with boating, skiing, wake boarding, fishing, and sailing on Beaver Lake's approx 300 acres with depths up to 50'! Beaver Lake also features a private clubhouse, pool, playground, sand beach, pavilion, marina, golf course, and much more! Conestoga/Murray Public Schools.

## PROPERTY FEATURES

---

- Custom, yet Classy Trims and Finishes Throughout
- Custom Sliding Barn Doors to Dining Room
- 12'x9' Glass Sliding Doors Upstairs and Downstairs
- Custom Rustic Cedar Bar with Galvanized Metal Facing
- Custom-Built Theater Seating, wired for Surround Sound
- Custom-Built Wet Bar with Concrete Countertops
- Walk-In Tile Master Shower with Soaker Tub
- Rare Antique Mirror Kitchen Backsplash
- Custom Built-In Wine Cabinets
- Granite Countertops in Kitchen/Bathrooms/Laundry
- Granite Kitchen Sink
- Huge 14x60' Deck Overlooking Lake
- Over-Garage Bonus Room for Office/Playroom/Bdrm
- Fenced-In Dog Run Behind Garage

## WHAT'S NEARBY?

---

### Education

- Conestoga Elementary School
- Conestoga Middle School
- Conestoga High School

### Parks

- Fontenelle Forest (22.2 mi)
- Schramm Park State Rec Area (27.6 mi)
- Eugene T. Mahoney State Park (29.4 mi)

### Grocery

- 75 Mart (2.9mi)
- No Frills Supermarket (8.3 mi)
- Hy-Vee (8.6 mi)

### Restaurants

- D&E's Lakeside Pizza and Subs (1.48 mi)
- Lake Ridge Golf Course (1.2 mi)
- Beyond BBQ (8.2 mi)

### Coffee Shops

- Scooters Coffee (8.5 mi)
- Starbucks (8.6 mi)
- Herban Coffee Lab (9.1 mi)

### Golf Courses

- Lake Ridge Golf Course (1.2 mi)
- Bay Hills Golf Club (13.4 mi)
- Tregaron Golf Course (16.1 mi)



**Cory Fuller**  
Omaha Fuller Group  
BHHS Ambassador Real Estate



c: (402) 680-2393  
e: cory.fuller@bhhsamb.com  
w: www.402HomeTeam.com



# FLOOR PLAN

8821 Verdon Circle

SIZES AND DIMENSIONS ARE APPROXIMATE.  
ACTUAL MAY VARY.

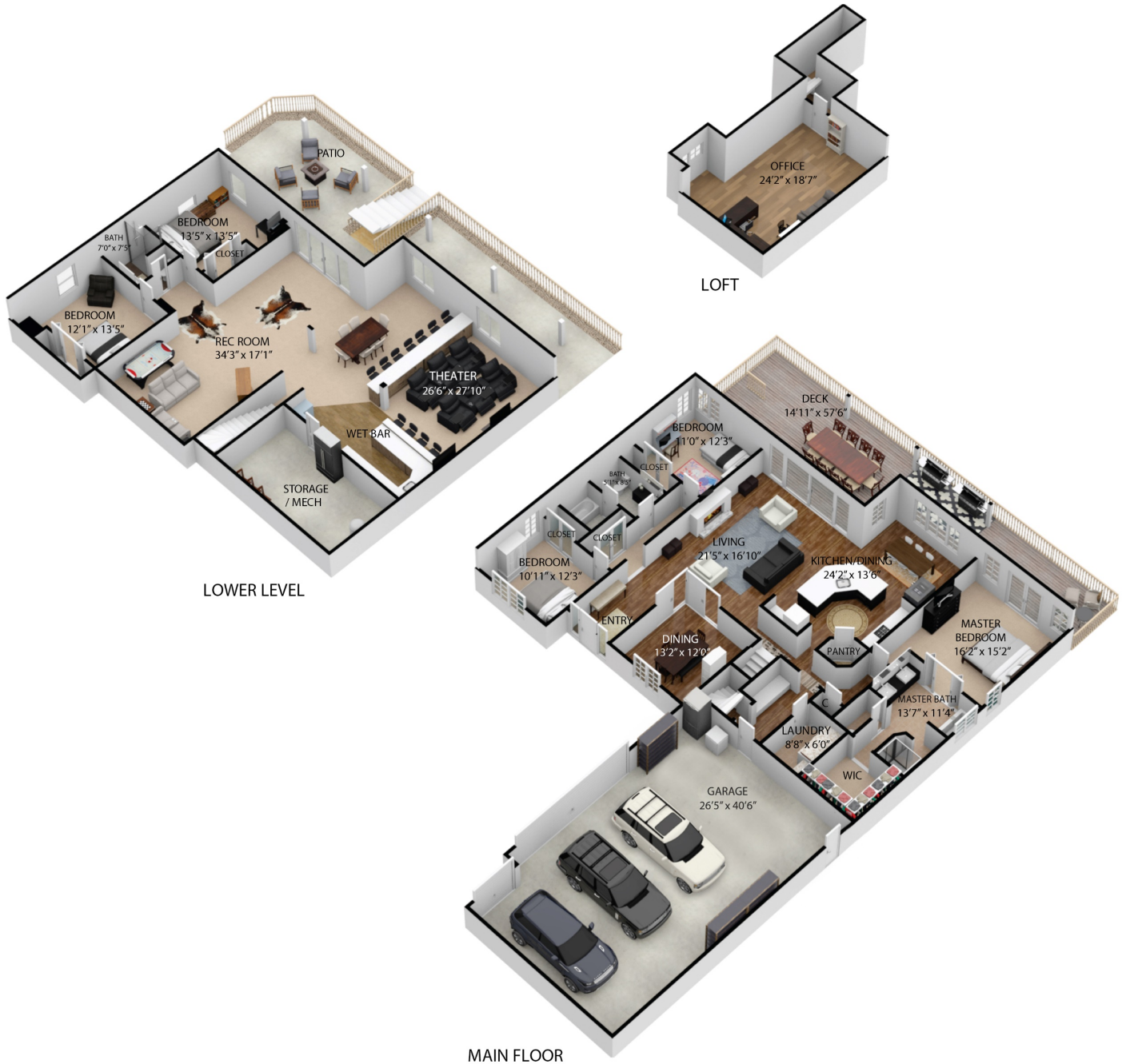

**Cory Fuller**  
Omaha Fuller Group  
BHHS Ambassador Real Estate



c: (402) 680-2393  
e: cory.fuller@bhhsamb.com  
w: www.402HomeTeam.com