



Darin Whitmer

c: (402) 720-1241

e: dwhitmer@dodgecountyrealtygroup.com

w: dodgecountyrealtygroup.com



112 N PINE ST

MAIN FLOOR

112 N PINE ST

SIZES AND DIMENSIONS ARE APPROXIMATE. ACTUAL MAY VARY.

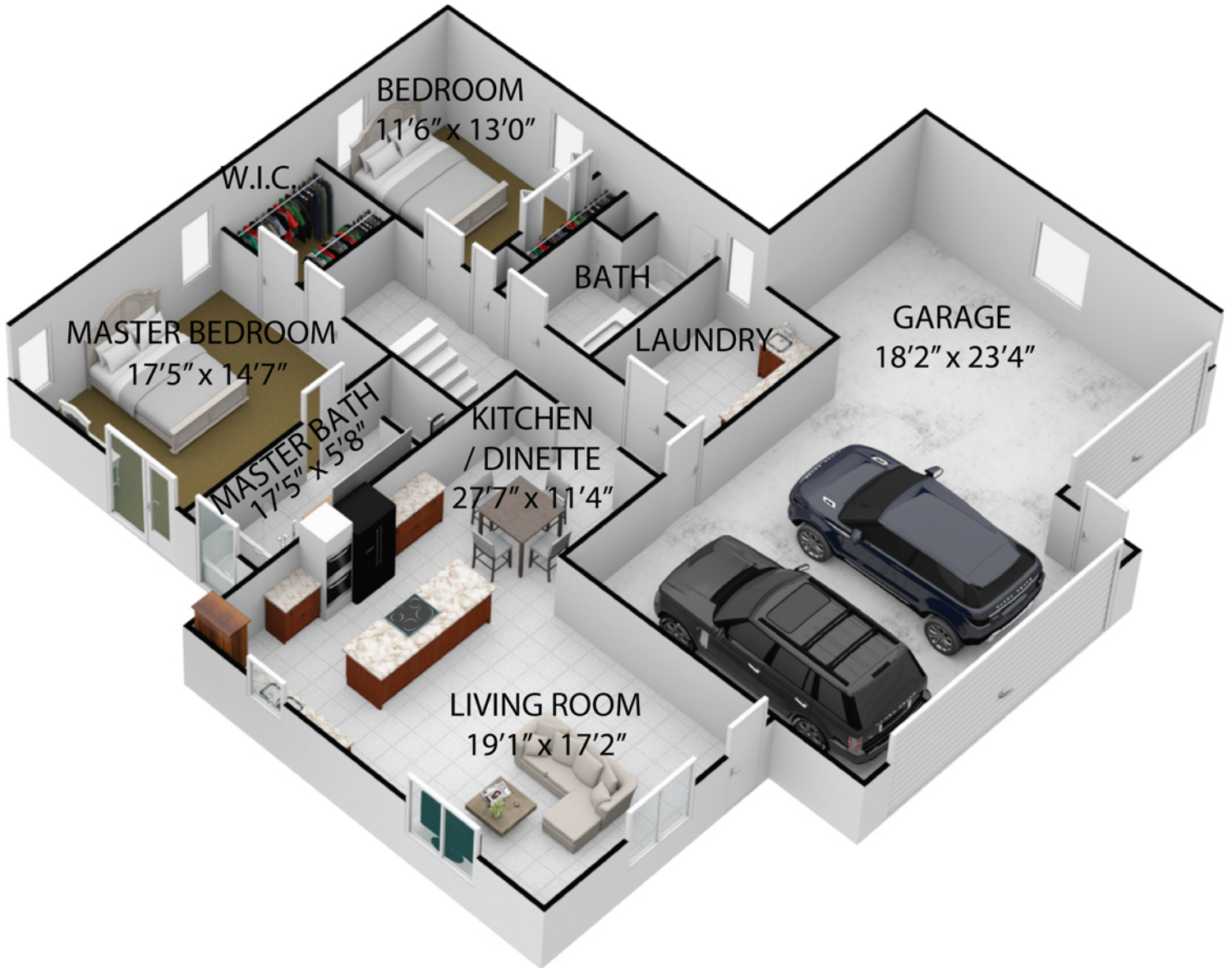

Darin Whitmer

c: (402) 720-1241

e: dwhitmer@dodgecountyrealtygroup.com

w: dodgecountyrealtygroup.com

LOWER LEVEL

112 N PINE ST

SIZES AND DIMENSIONS ARE APPROXIMATE. ACTUAL MAY VARY.

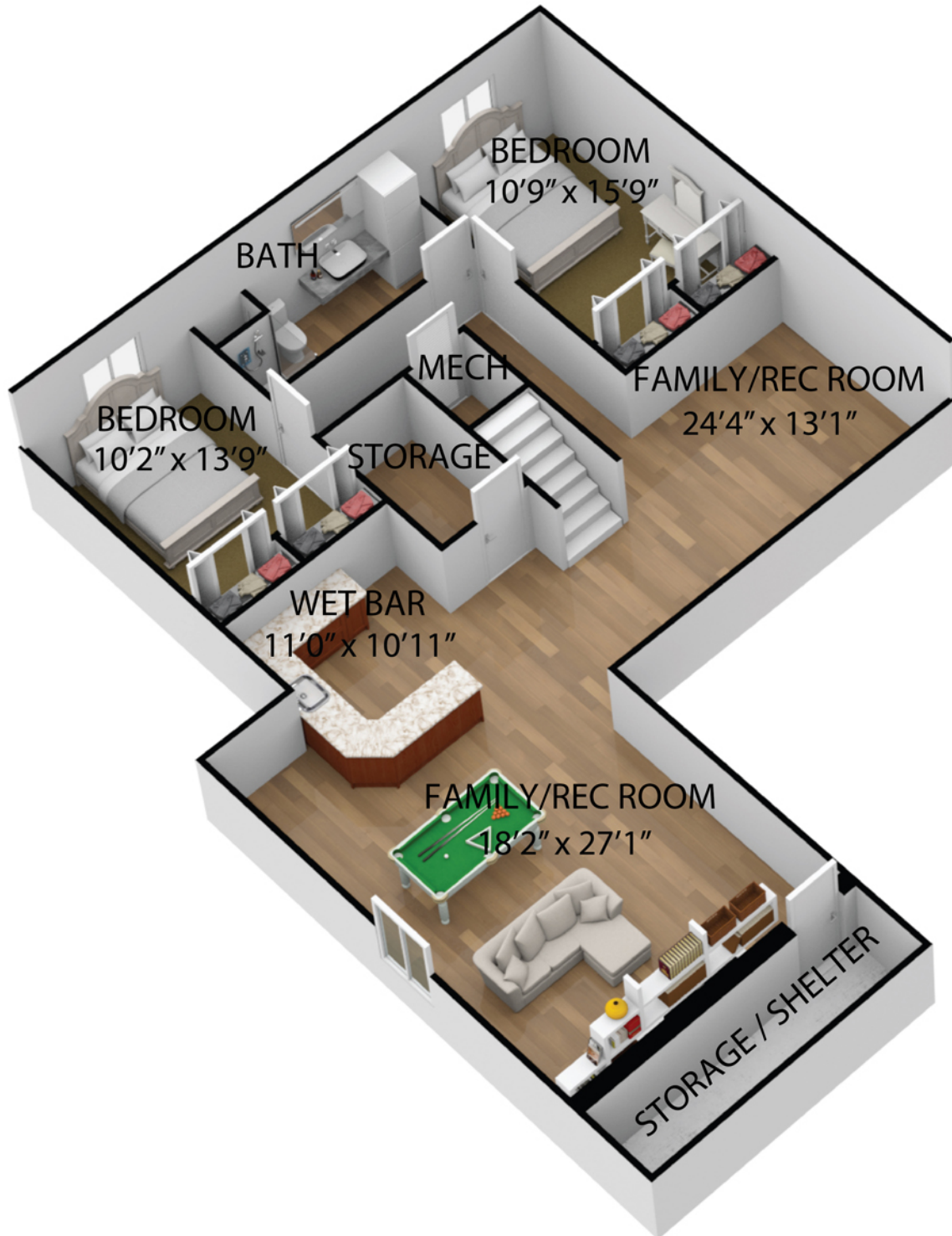

Darin Whitmer

c: (402) 720-1241

e: dwhitmer@dodgecountyrealtygroup.com

w: dodgecountyrealtygroup.com