



Sam Heineman

o: (402) 719-9269

e: sheineman@dodgecountyrealtygroup.com

w: www.dodgecountyrealtygroup.com



2851 HOGAN LANE

MAIN FLOOR

2851 HOGAN LANE

SIZES AND DIMENSIONS ARE APPROXIMATE. ACTUAL MAY VARY.

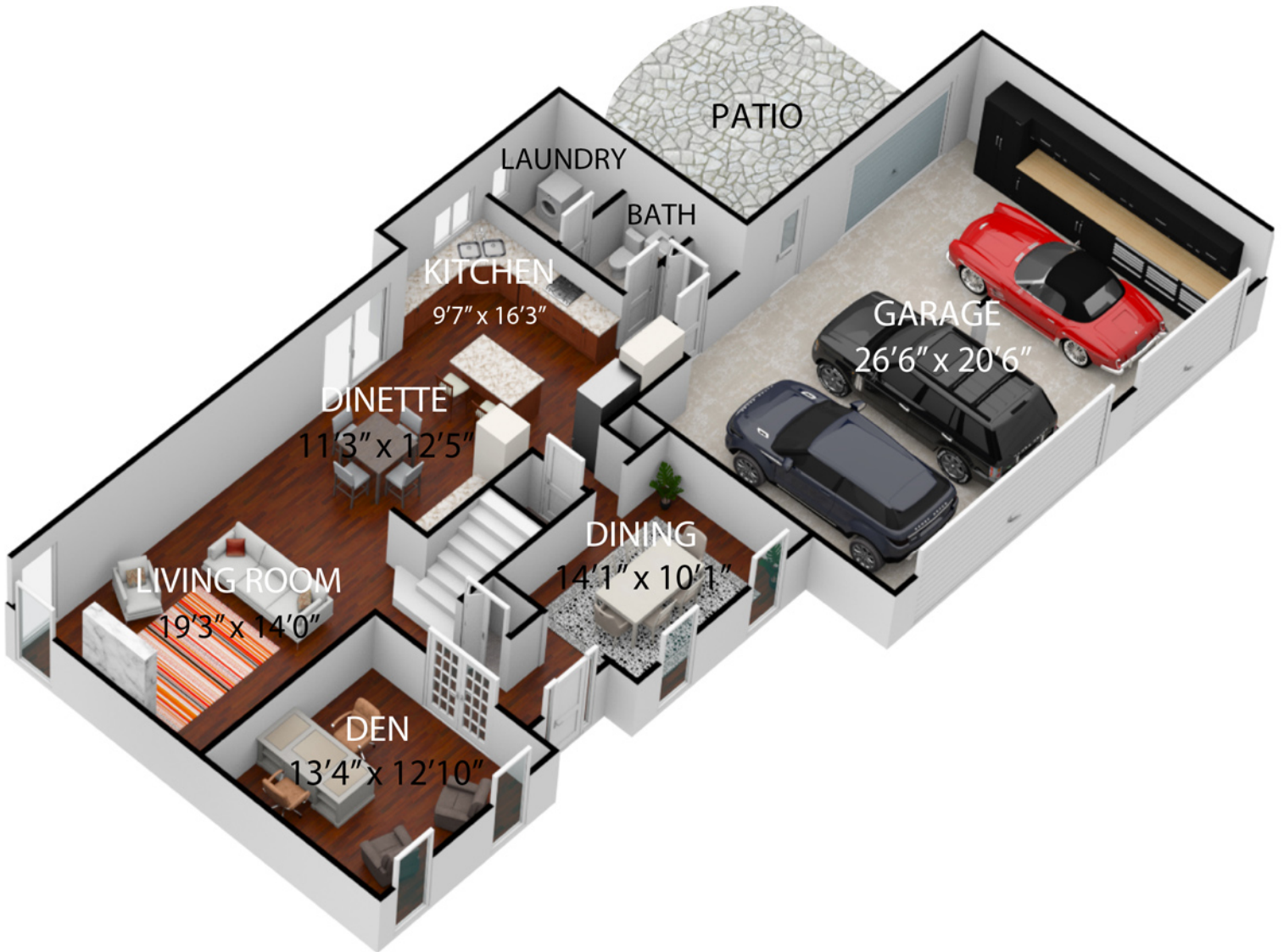

Sam Heineman
o: (402) 719-9269
e: sheineman@dodgecountyrealtygroup.com
w: www.dodgecountyrealtygroup.com

FLOOR 2

2851 HOGAN LANE

SIZES AND DIMENSIONS ARE APPROXIMATE. ACTUAL MAY VARY.

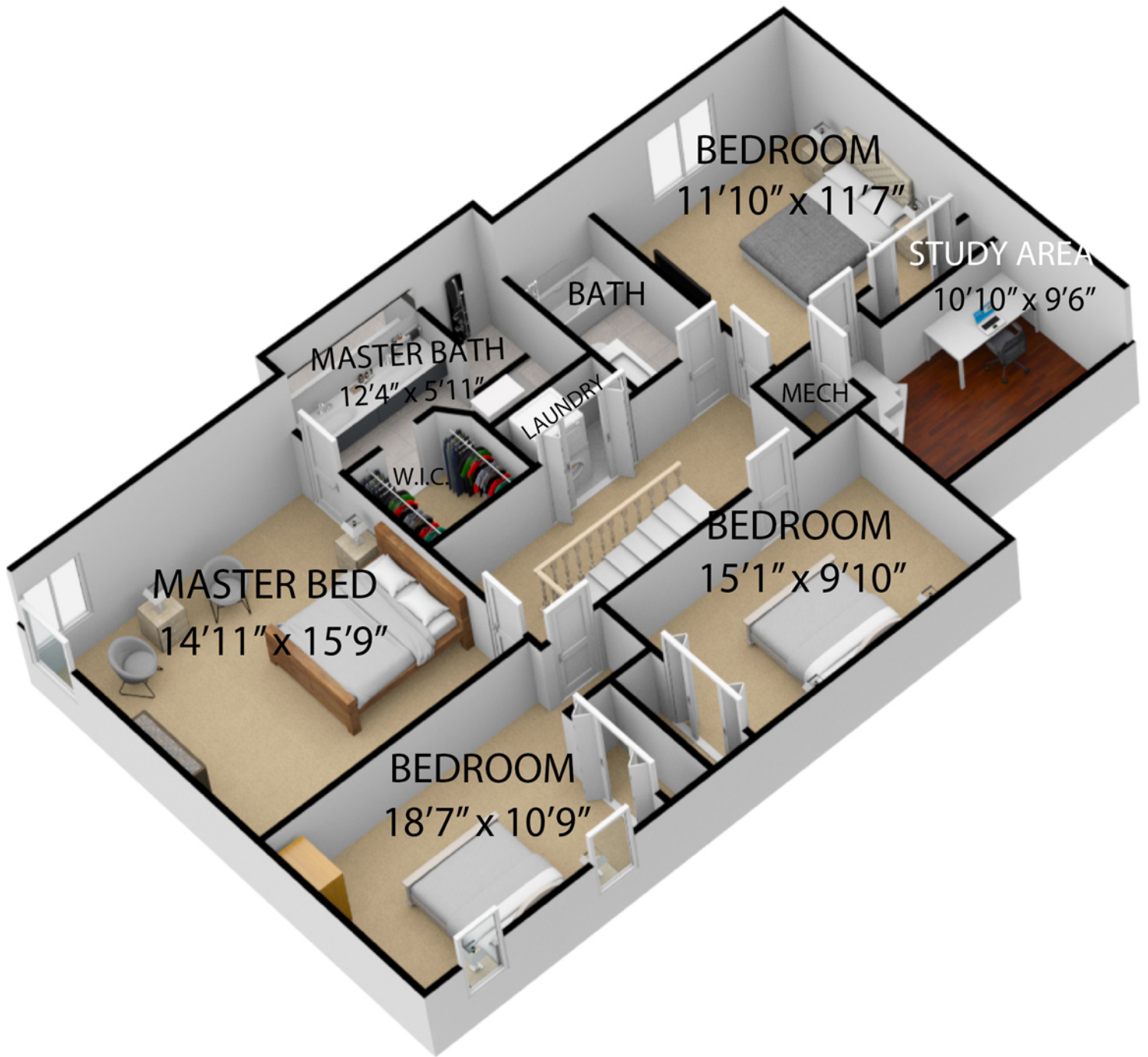

Sam Heineman
o: (402) 719-9269
e: sheineman@dodgecountyrealtygroup.com
w: www.dodgecountyrealtygroup.com

LOWER LEVEL

2851 HOGAN LANE

SIZES AND DIMENSIONS ARE APPROXIMATE. ACTUAL MAY VARY.

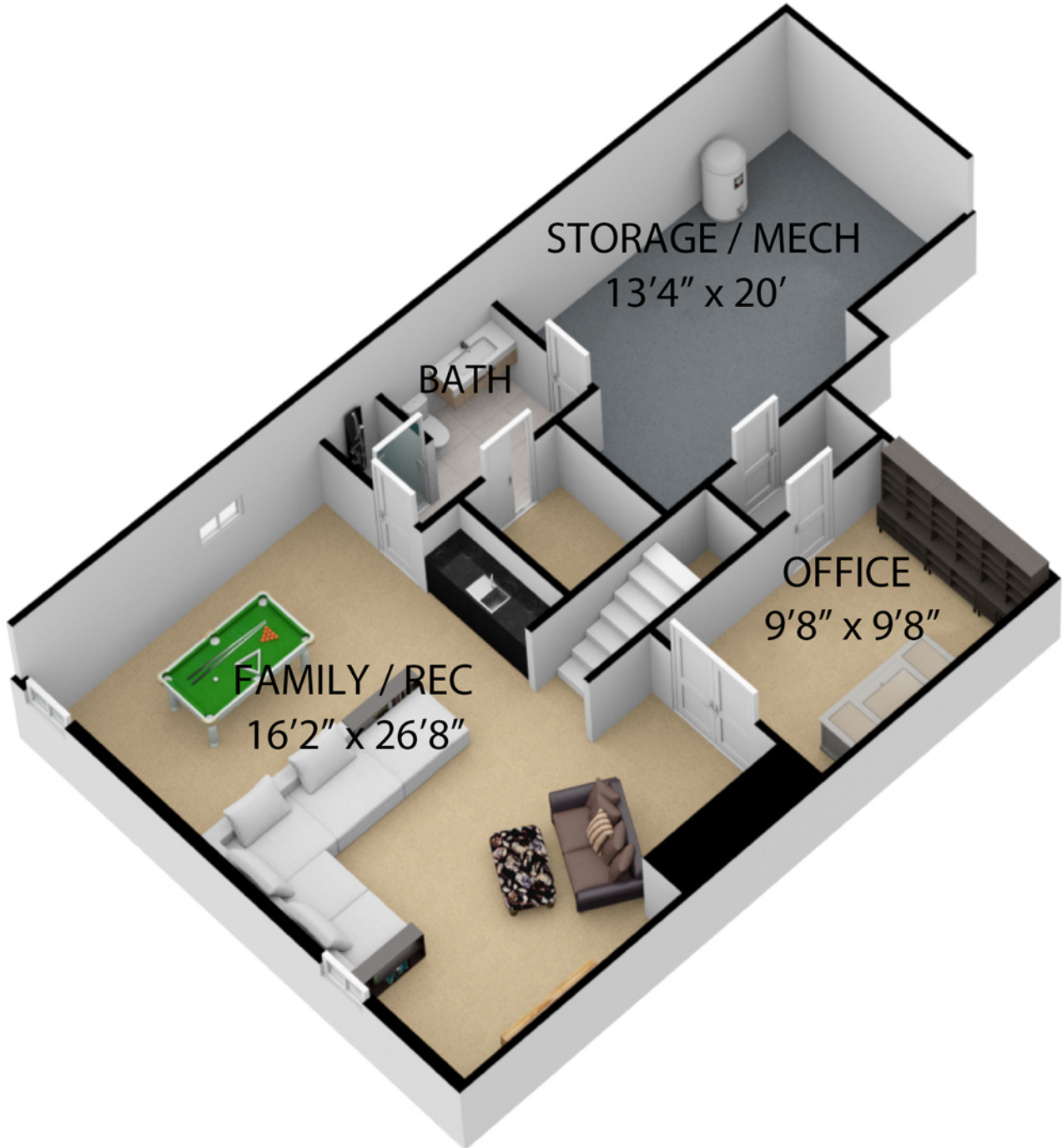

Sam Heineman
o: (402) 719-9269
e: sheineman@dodgecountyrealtygroup.com
w: www.dodgecountyrealtygroup.com