

ECHELONHOMES



22007 Kent Cir
Elkhorn, NE 68022



3,571 Sqft



5 bed, 3 bath



\$629,900



<https://realestate.lifestyle360vr.com/listings/22007-kent-cir/>



THIS HOME IS
ALWAYS OPEN ONLINE™
TAKE A VIRTUAL TOUR!



Chelsea Nelson
BHHS Ambassador Real Estate

c: 402-657-8905
e: chelsea.nelson@bhhsamb.com
w: chelseanelson.lifestyle360vr.com

Description

Nestled on a cul-de-sac, this new construction modern farmhouse crafted by Echelon Homes will impress you the minute you walk through the grand double door entry. The expansive great room will feature 12' tall ceilings and floor to ceiling windows that provide a wonderful view of the landscaped lot with no rear neighbors. European style frameless cabinets in the kitchen feature soft close hardware compliment the high-end appliances and Cambria Quartz countertops. This house is perfect for entertaining, whether you prefer to grab a drink around the oversized bar in the rec area of the basement or catch a glimpse of the stars while enjoying the built-in firepit on the exterior patio. Located in the desired Prairies subdivision, which features a clubhouse, pool and walking trails, this house is a must see.

Property Features

- 12' Vaulted Great Room Ceiling
- Cambria Quartz Countertops and Vanity Tops
- Covered Composite Deck
- Covered Porch
- Dual Vanities
- European-Style Frameless Cabinets
- Patio
- Tile Gas Fireplace
- Wet Bar
- Floor-to-Ceiling Windows
- Gas Fire Pit
- Hardwood-Style Flooring
- High-End Modern Finishes and Fixtures
- High-End Stainless Steel Appliances
- Pass-Through Laundry to Master Closet
- Walk-In Pantry
- Walk-In Tile Shower

What's Nearby?

Grocery

- Fareway Stores (5.37 mi)
- Hy-Vee (3.64 mi)
- Family Fare Supermarket (1.73 mi)

Shopping

- Village Pointe Shopping Center (4.27 mi)
- Bath & Body Works (4.18 mi)
- Jos A. Bank (4.44 mi)

Restaurants

- 402 eat + drink (4.46 mi)
- Jukes Ale Works (3.38 mi)
- Javi's Tacos (4.23 mi)

Coffee Shops

- Stir Coffee Bar (4.35 mi)
- Fala's Treasures & Coffee House (3.39 mi)
- Green Beans Coffee (5.6 mi)

Parks

- Lawrence Youngman Park (2.98 mi)
- Two Rivers SRA (4.9 mi)
- Coyote Run Spray Ground (3.56 mi)



Chelsea Nelson
BHHS Ambassador Real Estate

c: 402-657-8905
e: chelsea.nelson@bhhsamb.com
w: chelseanelson.lifestyle360vr.com

FLOOR PLAN

22007 Kent Cir

SIZES AND DIMENSIONS ARE APPROXIMATE.
ACTUAL MAY VARY.

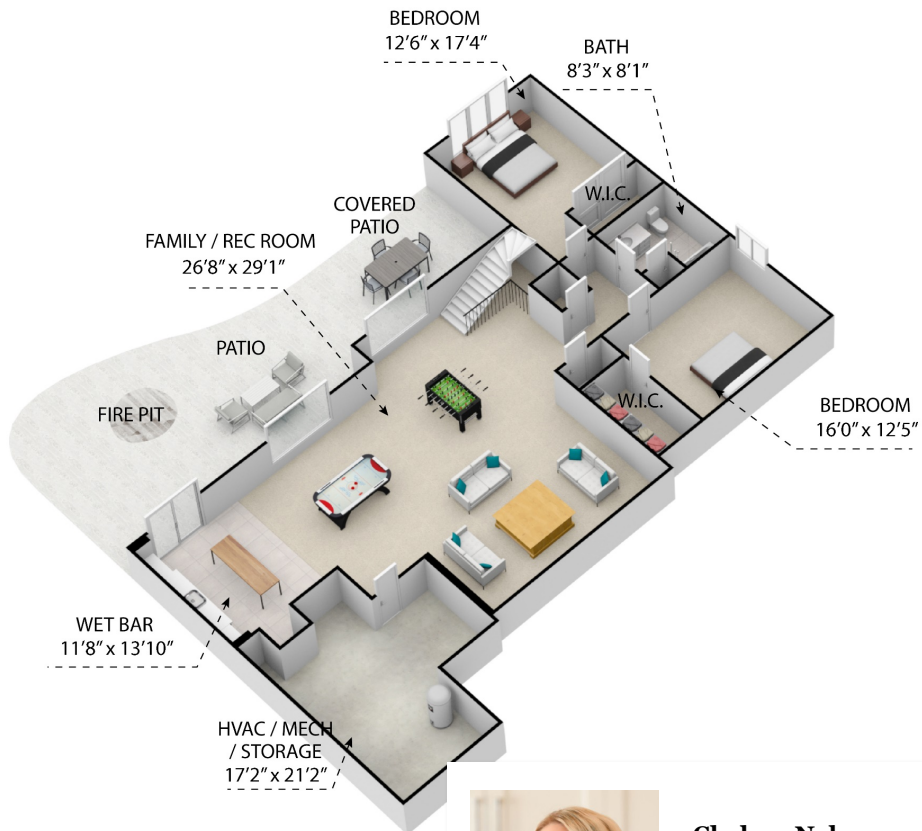

Chelsea Nelson
BHHS Ambassador Real Estate

c: 402-657-8905
e: chelsea.nelson@bhhsamb.com
w: chelseanelson.lifestyle36ovr.com

