



2768 1st Ave
Columbus, NE 68601



1,075 Sqft



4 bed, 2 bath



\$312,500



<https://realestate.lifestyle360vr.com/listings/2768-1st-ave/>



**THIS HOME IS
ALWAYS OPEN ONLINE™
TAKE A VIRTUAL TOUR!**

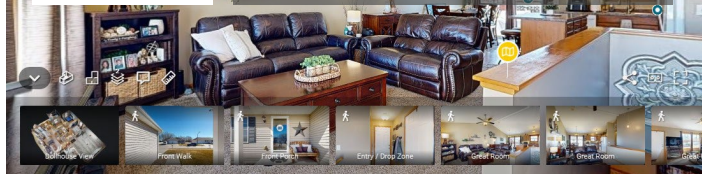

Dallas Thelen

c: (402) 276-7616
e: dallas@c21rt.com
w: dallasthelen.c21.com

DESCRIPTION

This beautiful home built in 2008 boasting 4 bedrooms, 2 baths, and a 2 car garage has all the work done and is ready for its new owner! This property offers spacious living areas perfect for both relaxation and entertaining. The open kitchen, dining, and living room area with cathedral ceiling creates an exciting atmosphere for gatherings. Kitchen also has undercabinet lighting, a breakfast bar, and all appliances are included! The basement has plenty of room for game nights or to watch your favorite shows! Already plumbed/stubbed for potential 3rd bathroom. Large storage room including washer, dryer, and water softener! Enjoy outdoor activities and gatherings on the large patio amidst the beautifully-landscaped yard complete with gazebo, storage shed, and wooden playset! Garage wired for 220V. Located in Cherry Creek subdivision on East side of town close to shopping area! Don't miss out on the opportunity to make this delightful property your new home! Sale is subject to seller finding suitable housing. Seller prefers 6/7/24 closing date.

WHAT'S NEARBY?

Grocery

- Walmart Supercenter (0.58 mi)
- Hy-Vee Fast & Fresh (1.91 mi)
- Super Saver (2.16 mi)

Shopping

- The Village Centre (0.9 mi)
- Bomgaars (3.1 mi)

Restaurants

- Reeder's 11th St Grub & Pub (1.94 mi)
- Dusters (2.01 mi)
- CK Grill and Bar (2.95 mi)

Coffee Shops

- The Broken Mug (1.83 mi)
- Starbucks (1.89 mi)
- 38th St Coffee (2.71 mi)

Park

- Centennial Park (2.2 mi)
- Pawnee Park (4.1 mi)
- Gerrard Park (4.1 mi)



FLOOR PLAN

2768 1ST AVE

SIZES AND DIMENSIONS ARE APPROXIMATE. ACTUAL MAY VARY.

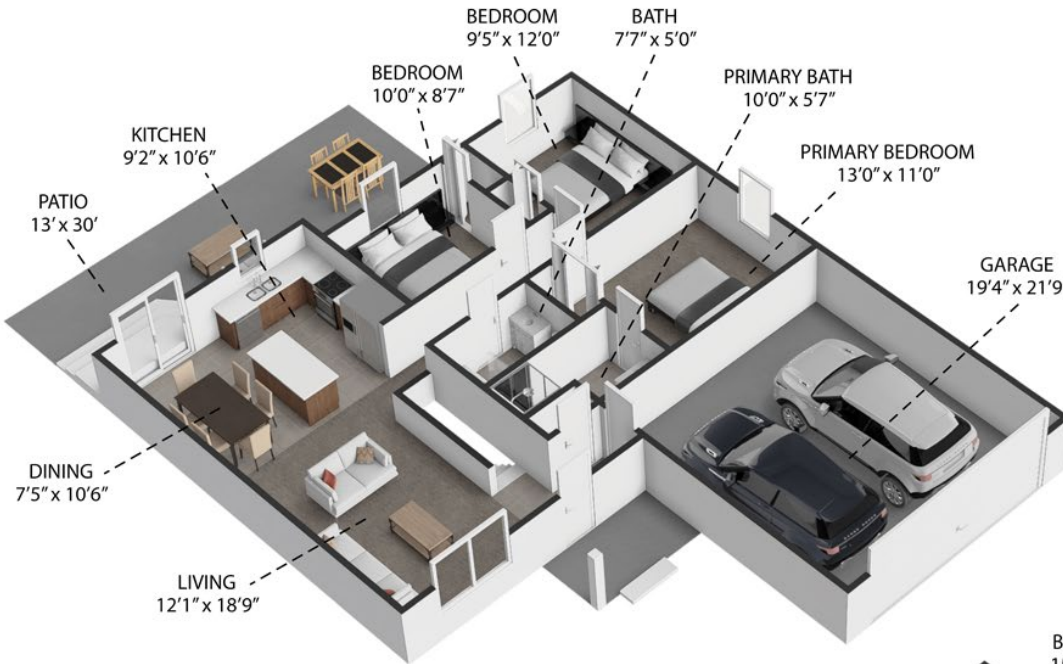

MAIN FLOOR



LOWER LEVEL

